



DC MICROWAVE PLUG - REMOVAL/INSTALLATION

1. Removal of the DC Microwave Plug

A. Reference Information

Reference	Designation
AMM TASK XX-XX-XX-910-801	Electrical/Electronic Safety Precautions

B. Tools and Equipment

Reference	Designation
GSE XX-XX-XX	Tag, Circuit Breaker

NOTE: Refer to the XXXXX Listing to make sure you use the correct XXX configuration.

C. Setup

- (1) Obey all the electrical/electronic safety precautions (AMM TASK XX-XX-XX-910-801).
- (2) Remove the microwave (SMM X).

D. Procedure

Refer to Figure 401.

- (1) Disconnect the microwave electrical connector.
- (2) Put protective covers on the electrical connections.
- (3) Remove the screws, washers, and spacers securing the mounting plate to the galley.
- (4) Remove the screws and washers securing the plug to the mounting plate.
- (5) Remove the plug.

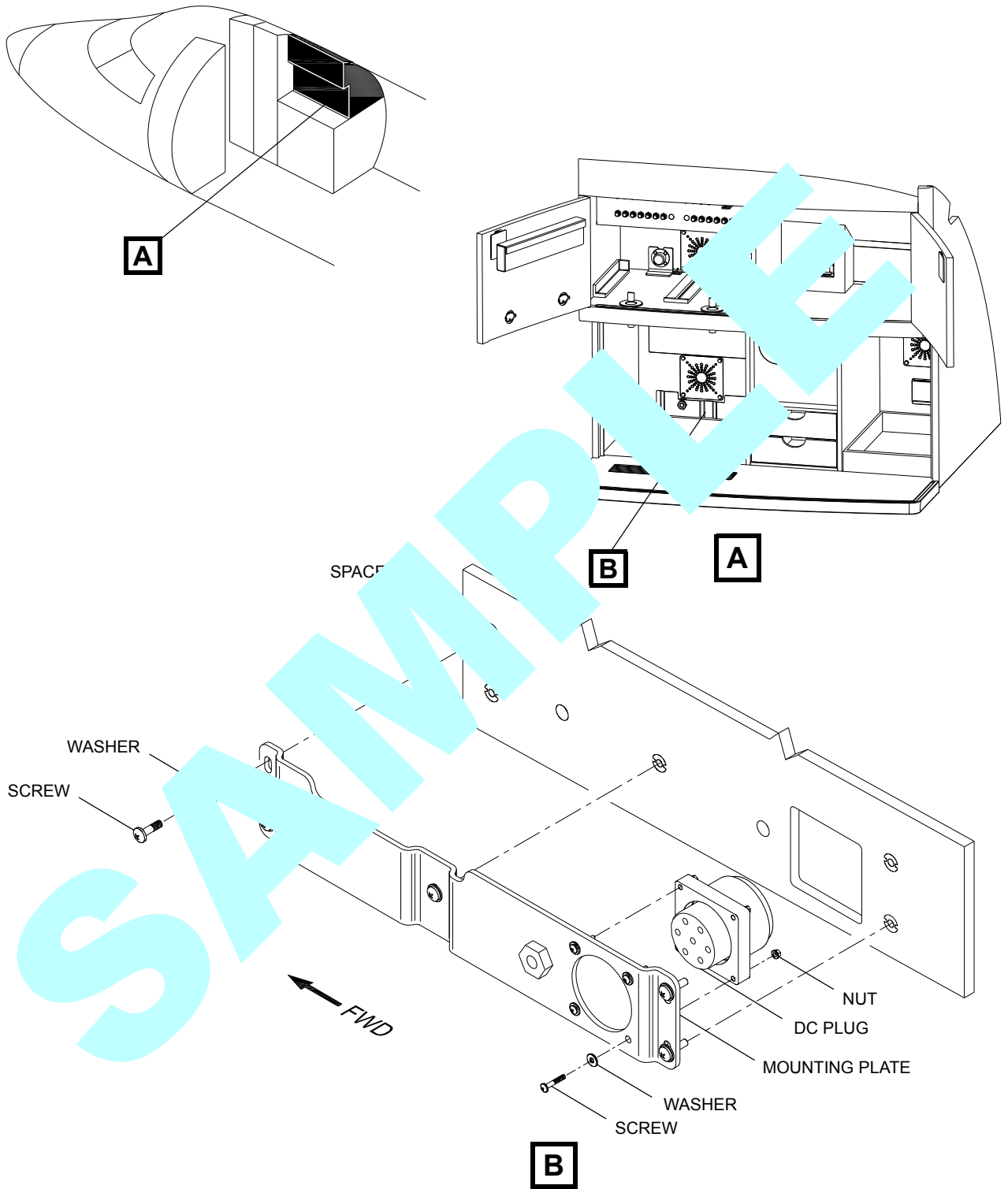

Copyright © 2008 by AEC, Inc. All rights reserved.

DC Microwave Plug - Removal/Installation
Figure 401

EFFECTIVITY: XXXX-SMM
Revision FI

2. Installation of the DC Microwave Plug

A. Reference Information

Reference	Designation
AMM TASK XX-XX-XX-910-801	Torquing of Threaded Fasteners

B. Tools and Equipment

Reference	Description
Commercially Available	Wrench, Torque

NOTE: Refer to the XXXXX Listing to make sure you use the correct torque specification.

C. Setup

- (1) Make sure that the aircraft is in the specified configuration for this removal task.

D. Procedure

Refer to [Figure 401](#).

NOTE: Make sure that the mounting surface is clean with no corrosion, paint, grease, or preservation fluids.

- (1) Remove the screws securing the connector.
- (2) Connect the microwave plug to the electrical connector.
- (3) Position the microwave plug on the mounting plate.
- (4) Install the spacers and washers securing the plug to the mounting plate.
- (5) Torque the screws securing the plug (AMM TASK XX-XX-XX-910-801).
- (6) Torque all the screws, washers, and spacers securing the mounting plate to the galley.
- (7) Perform an operational test of the microwave (SMM XX-XX-XX).
- (8) Do an operational test of the microwave (SMM XX-XX-XX).
- (9) Torque the screws securing the mounting plate (AMM TASK XX-XX-XX-910-801).

E. Closeout

- (1) Remove all tools, equipment, and unwanted materials from the work area.